

LFT3100 Temperature and Pressure Sensor

LEFOO 力夫

Features

- Adopt diffusion oil-filled silicon core
- High accuracy, high overload capacity
- Dual output in temperature and pressure, compact structure
- Support Modbus-485 communication protocol (intelligent type)
- Integrated temperature sensor and pressure sensor in one transmitter



Description

LFT3100 Temperature and Pressure Transmitter adopts advanced piezoresistive pressure sensor and PT-100 temperature sensor, which can convert pressure and temperature value into standard signal(current or voltage) output through a special signal conditioning circuit. It has advanced digital temperature compensation, wide operating temperature range and varieties of output signals, can meet customers' different requirements. This Transmitter can be used to monitor pressure and temperature in crude oil, foods processing, water treatment system, and other industries.

Specification

Measurement Range	0~10KPa...70MPa		
Temperature Range	-20~100°C PT-100		
Overload Pressure	1.5 times of rated pressure		
Accuracy	Pressure: $\pm 0.5\%$ F.S; Temperature $\pm 2\%$ F.S		
Stability	<0.5% F.S/Year		
Working Temperature	-20~+85°C		
Storage Temperature	-40~+100°C		
Medium Compatibility	Gas or liquid compatible with 304 and 316L stainless steel, fluorine rubber or nitrile rubber		
Electrical Performance	2-wired	3-wired	4-wired
Output Signal	4~20mA	0.5-4.5VDC	RS-485
Power Supply	10~30VDC	4.75~5.25VDC	10~30VDC
Electrical Connection	DIN43650A(Big Hirschmann), M12 Waterproof outlet, M12 Aviation connector		
Enclosure Protection	IP65		
Pressure Connection	G1/4, M12*1, M10*1, NPT1/4, G1/2, M20*1.5, etc.		
Pressure Form	Gauge pressure / Absolute pressure		
Certification	Safety Explosion-proof Type E, RoHS, EU Electrical Safety Standards CE		

LFT3100 Temperature and Pressure Transmitter

LEFOO 力夫

Dimension in:mm

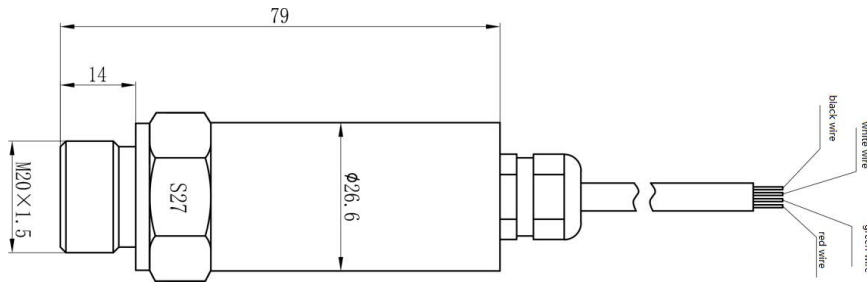

Order Ref NO.

Code and Description		Remark						
T3100		Model						
Pressure Range	0~10Kpa...70MPa		Measurement Range					
Temperature Range	-20~100°C							
A4	A4 = 4~20mA (Two-wired)		Output Mode					
V05	V05 = 0.5~4.5V (Three-wired)							
RS	RS=RS-485							
K	K = kpa	P	P = psi	Measurement Unit				
M	M = Mpa	B	B = bar					
0.5	0.5 = 0.5%F.S		Accuracy Grade					
D1	D1 = DIN43650A (Big Hirschmann)		Electrical Connection					
M	M = M12 (M12 Aviation connector)							
C	Cable (C3=3-core aviation connector,C4=4-core aviation connector)							
G	G = G1/4	G2	G2 = G1/2	Pressure Connection				
N	N = NPT1/4	M2	M2= M20*1.5					
M1	M1= M10*1	M3	M3 = M12*1					
1.0	1.0 = 1m		Cable Length					
2.0	2.0 = 2m							
3.0	3.0 = 3m							
T3100	0-60/0-100°C	A4	M	0.5	M	G	1.0	Model Selection Example