

FEATURES

- High-precision MEMS micro-pressure core, high precision and wide operating temperature range;
- Clear LCD digital display
- Zero button available on-site, wind speed range adjustable
- Strong stability and long service life
- IP65 protection grade housing



DESCRIPTION

LFS72 Explosion-proof Air Velocity Transmitter is suitable for gas flow measurement in Explosion-proof environments. It can convert the flow rate of gas into an electrical signal and transmit it to the control system. The range can be adjusted on-site through buttons, and the IP65 protection grade casing is used. It is suitable for energy management systems, VAV and fan control, environmental pollution control, smoke hood control, oven and boiler ventilation control and other fields.

SPECIFICATION

Measurement Medium	Air or neutral gas
Range	Speed: 0~10 m/s, 0~20 m/s, 0~30 m/s, 0~40 m/s(Range can be customized.)
Over Voltage	10KPa
Accuracy	±3.0%FS(Speed > 3 m/s)
Working Temperature	Host machine: -20℃~80℃ ; Probe: -40℃~450℃
Compensation Temperature	-10℃~60℃
Storage Temperature	Host machine: -40℃~85℃
Response Time	0.5s(default) /1.0s /2s /4s
Protection Degree	IP65
Pressure Connection	Stainless steel 1/2" quick connection
Output Signal	4~20mA / 0~10VDC / RS485
Power Supply ①	12~30VDC / 24VAC ± 20%
Power Dissipation	≤1.5W
Shell Material	Cast Aluminium
Communication	RS-485 standard interface, Modbus RTU protocol
Certification	ROHS, CE
Explosion-Proof Cert	EXd IIC T6 Gb
Display	LCD digital display
Weight (Approximate)	Host machine: 1362g

①When the product is powered by AC power, it is recommended to use an isolated AC power supply.

DIMENSION(mm)

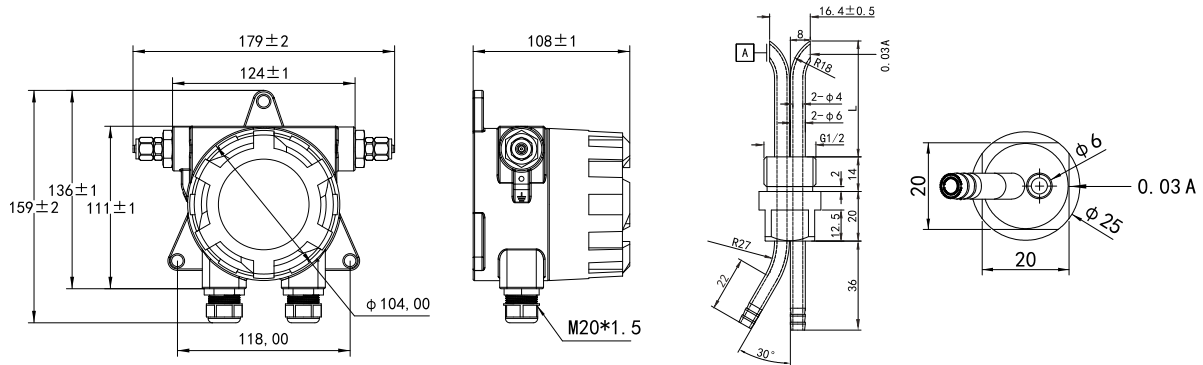

WIRING

① NOTE:

Wiring should be performed by qualified technicians. When wiring, the transmitter must be powered off.

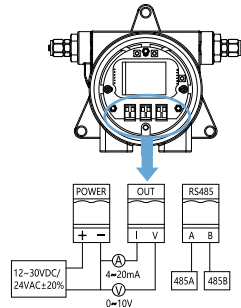

② Specific operation steps for wiring:

(Note: Wire diameter D must meet: 7mm≤D≤12mm)

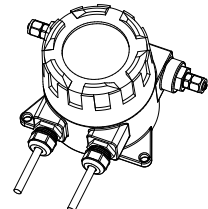
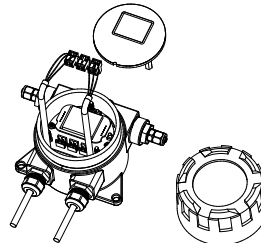
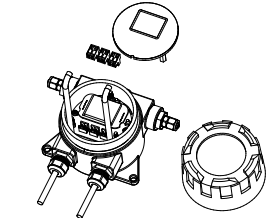
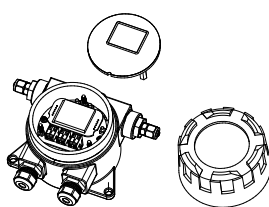
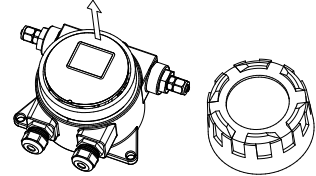
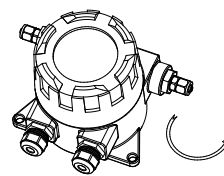

INSTALLATION

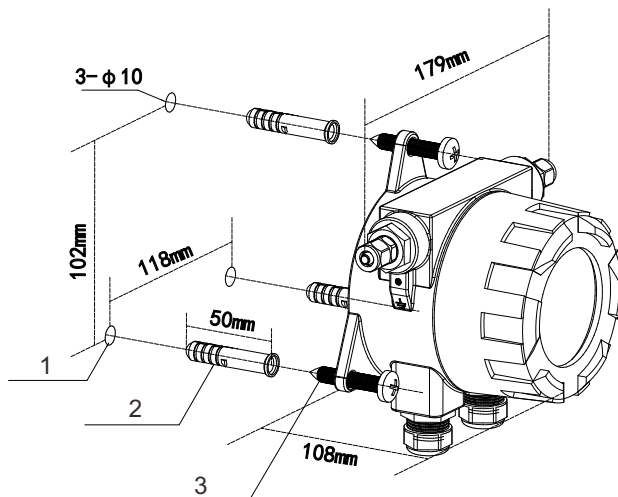

1. Drill
2. Embedding expansion pipes
3. Lock the product with screws

ORDER REF NO.

Code and Description			Remark
LFS72-			Model
	1	0~10m/s	Air Velocity Range
	2	0~20m/s	
	3	0~30m/s	
	4	0~40m/s(L-type pitot tubes only)	
	X	Customized	
	A	4~20mA / RS485	Output Mode
	B	4~20mA / 0~10VDC	
	C	0~10VDC / RS-485	
LFS72-2A	Range: 0~20m/s, Output: 4~20mA/RS-485 Double Output		Example