

## LFH51 Probe Type Temperature and Humidity Transmitter

### FEATURES

- Small size, easy installation
- Power supply and output with overvoltage protection and reverse polarity protection
- 12-36VDC wide range power supply
- High protection grade design, up to IP65



### DESCRIPTION

LFH51 Temperature and Humidity Transmitter adopts high-precision digital probe, which has good long-term stability and anti-interference ability, small size, simple installation and easy operation. There are two output modes of voltage and RS485 to choose from. It is widely used in ventilation ducts, industrial workshops, warehouses and other places that need to measure temperature and humidity.

### SPECIFICATION

#### 1)Relative humidity

Sensor	Digital
Measurement Range	0%~100%
Output	RS485/Modbus, 0~10VDC
Accuracy	±3%@ 20°C & 60%RH

#### 2)Temperature

Sensor	Digital
Output	RS485/Modbus, 0~10VDC
Accuracy	±0.3°C@20°C see the Table below
Power Supply	12-36VDC
Shell Material	PC shell
Working Environment	-40~85°C, 5%-95%RH (Non-condensing)
Protection Level	IP65

## TEMPERATURE ACCURACY CURVE

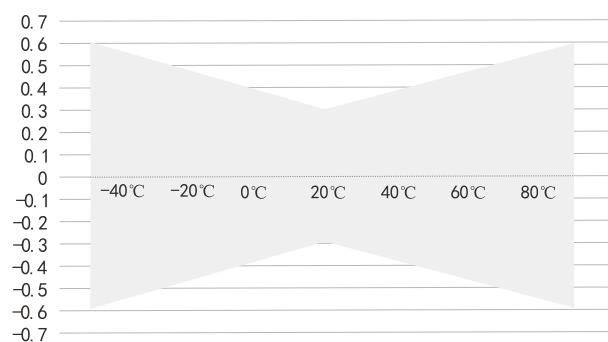

## DIMENSION (mm)

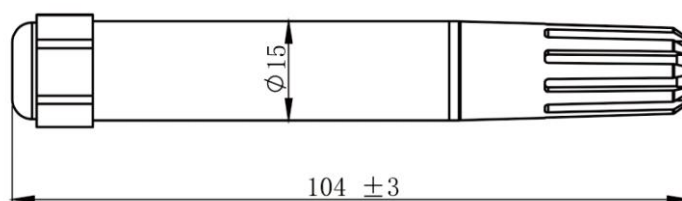

LFH51 Dimensions

## WIRING INSTRUCTIONS

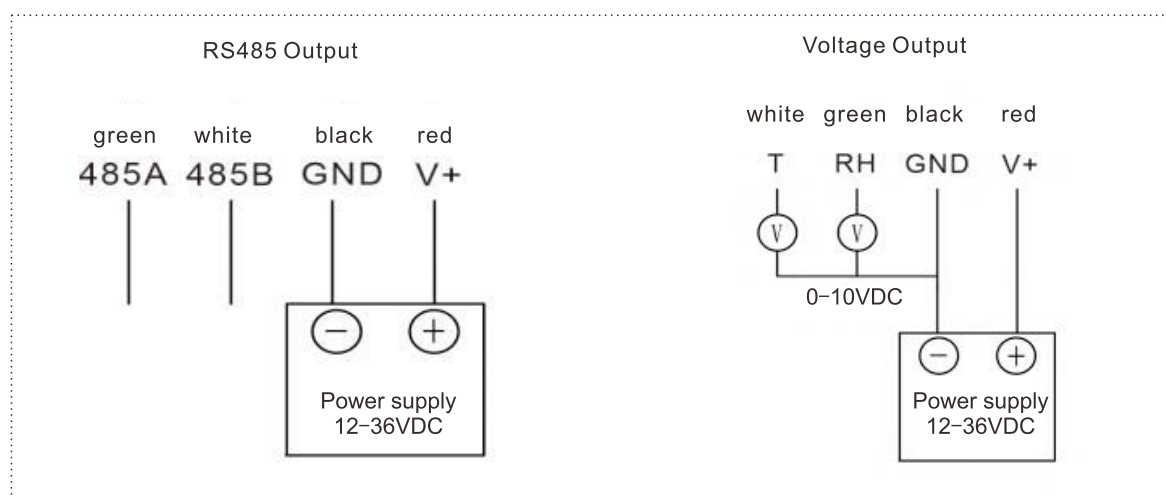

## PRODUCT INSTALLATION

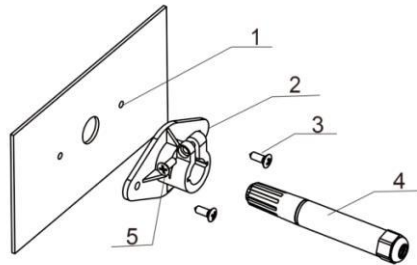

- ① Open installation hole;
- ② Install the mounting flange;
- ③ Tighten the fixing screws;
- ④ Insert the temperature and humidity transmitter and adjust its position;
- ⑤ Tighten the flat tapping screw.

## ORDER REF NO.

Code and description						Remark
LFH51-	Probe type temperature and humidity transmitter					Model
	3	±3%RH(±0.3℃)				Accuracy Range
		V10	0~10VDC(3-wire)			Humidity output
		RS	RS485/Modbus			
		V10	0~10VDC(3-wire)			Temperature Output
		RS	RS485/Modbus			
			0	No		Temperature Range
			1	0~50℃		
			2	-20~60℃		
			8	Others (customer specified)		
LFH51-	3	V10	V10	2	Selection Example	

1. Only when the temperature output option is V10, the corresponding temperature range 1-8 needs to be selected; otherwise, only 0 can be selected.
2. If the Transmitter probe of this product is exposed to high concentrations of chemical gases for a long time, may cause the reading of the sensor to shift.
3. Example LFH51-3V10V102 represents probe type Transmitter, temperature and humidity accuracy is  $\pm 3\%RH@20^{\circ}C$  &  $60\%RH(\pm 0.3^{\circ}C@20^{\circ}C)$ , humidity output 0-10VDC, temperature output 0~10VDC, temperature range -20 ~60 $^{\circ}C$ .

## CAUTIONS

1. Avoid close to heat sources, cold sources, or direct sunlight.
2. Not suitable for use in the environment of oil pollution, organic solvent and corrosive gas.
3. When in dust and other environments, the filter membrane of the probe must be cleaned regularly.
4. When not in use for a long time, please store it in a dry environment.