

Features

- Adopt 316L flat film sensor, anti-blocking, easy clean
- Measure the pressure of viscous liquid directly
- Adopt ASIC technology, digital compensation
- Excellent corrosion and wear resistance
- Threaded connection, easy installation



Description

LEFOO T2700 flat film anti-blocking pressure transducer is a small structure, with variety of electrical output connection available. For gauge pressure or absolute pressure applications, the diffused silicon flat film threaded sensor can measure viscous media directly, such as chemical coatings, paint detection systems, environmental protection, and coal mines, papermaking, food processing, polyurethane equipment, crude oil and other viscous media.

Specification

Measurement Range	0~35Kpa - 0~35MPa (Gauge pressure/ Absolute pressure) ,0~10Kpa				
Overload Pressure	1.5 time of full scales (Max.100Mpa)				
Burst pressure	3.0 time of full scales (Max.100Mpa)				
Accuracy	±0.5%F.S				
Stability	<0.5%F.S/Year				
Working Temperature	-20~+85°C				
Storage Temperature	-40~+100°C				
Measured Medium	All corrosive media compatible with 1Cr18Ni9Ti and NBR				
Output Mode	Two-wired	Three-wired			Four-wired
Output Signal	4~20mA	0.5~4.5V	0~5V	0~10V	RS485
Power Supply	10~30VDC	5VDC	12~30VDC		24VDC
Electrical Connection	DIN43650A (Big Hirschmann), M12 waterproof outlet, M12 aviation connector (3PIN, 4PIN)				
Protection Grade	IP65 / IP54				
Pressure Connection	G1/4、NPT1/4、R1/4、BPS1/4、G1/2、7/16-20UNF、M20*1.5 etc.				
Pressure Form	Gauge pressure / Absolute pressure				
Certification	RoHS, EU electrical safety standard CE				

Note 1: Measurement at 25°C which includes comprehensive accuracy of linearity, repeatability and hysteresis.

Dimension

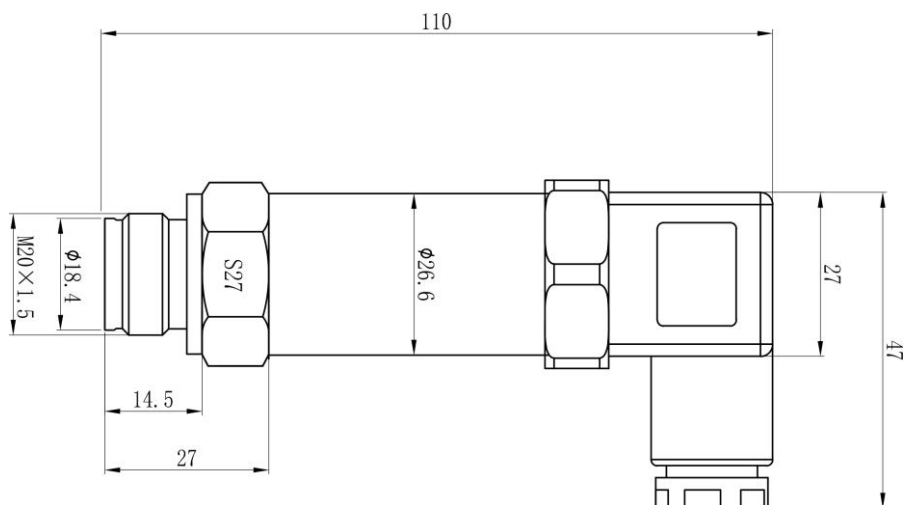

Electrical Connection

Electrical Connection	Ref. drawing	Electrical Connection	Ref. drawing
Packard		M12X1.5 Waterproof	
DIN43650A big Hirschmann		M12X0.75 four-pinhole aviation connection	
DIN43650C small Hirschmann		M12X0.75 three-pinhole aviation connection	

Order Ref NO.

Code and Description		Notes						
T2700		Model						
Range	0~35Kpa-0~35MPa (Gauge pressure/Absolute pressure), 0~10Kpa	Measurement range						
A4	A4 = 4~20mA (Two-wired)	Output mode						
V05	V05 = 0.5~4.5V (Three-wired)							
V0	V0 = 0~5V (Three-wired)							
V10	V10 = 0~10V (Three-wired)							
RS485	RS485 = RS485 output (Four-wired)							
K	K = kpa	P	P = psi	Unit				
M	M = Mpa	B	B = bar					
0.5	0.5 = 0.5%F.S			Accuracy class				
D1	D1 = DIN43650A (Big Hirschmann)			Electrical connection				
M	M = M12 (M12 Waterproof outlet)							
C	C = Cable (Three core aviation connector)							
C1	C1 = Cable (Four-core aviation connector)							
G	G = G1/2	M	M = M20*1.5	Pressure connection				
1.0	1.0 = 1m			Cable length				
2.0	2.0 = 2m							
3.0	3.0 = 3m							
T2000	0-60	A4	B	0.5	D1	G	1.0	Model selection example